

# Operating Manual

## FPS JD-2036R



**Carefully read chapter 3 all the way through before unpacking the implement.**

**Prior to using the implement for the first time read this operating manual carefully and conscientiously all the way through.**

**Keep this manual where it is easily accessible. This will enable you to refer to important information and handling instructions as needed.**

**The operating manual is part of the implement. The operating manual must always be provided with new and used machines.**

## Introduction

Dear customer!

Thank you for purchasing a product of matev GmbH, we appreciate your trust. You have acquired a quality product, if contrary to expectations you should have problems with the implement, contact your responsible sales partner.

Company stamp – sales partner

Prior to first use please read this operating manual carefully and conscientiously all the way through. The manual describes the handling of the implement in detail and will support you in working safely and effectively. By complying with the maintenance tasks you will retain the value and operational capability of the implement.

For damage that occurs due to operating errors or improper use, we will not accept any guarantee claims.

Variants may be described in the manual that do not agree with the scope of delivery of your implement.

Please enter the data of the rating plate on the implement in the manual. This information will be helpful in communication if there is a service case.

<b>matev</b> GmbH	
90579 Langenzenn	
CE	
Modell:	
Code Nr.:	
Fabr. Nr.:	
Baujahr:	
Ges.Gew.:	

**The implement is subject to change in the interest of technical progress. All information, illustrations, and technical specifications represent the latest status at the time this manual was published. The manufacturer reserves the right to make changes at any time in the interest of technical progress.**

Regards

matev GmbH

## Table of contents

---

### Table of contents

<b>1</b>	<b>About this operating manual</b>	<b>4</b>
<b>2</b>	<b>Safety</b>	<b>5</b>
2.1	Intended use	5
2.2	Instructions for the owner	5
2.2.1	Qualifications of personnel	5
2.2.2	Instruction	5
2.2.3	Accident prevention	6
2.3	General safety notices	6
2.4	Warnings on the machine	6
<b>3</b>	<b>Delivery and transport</b>	<b>8</b>
3.1	Delivery on a pallet	8
3.1.1	Lift the implement off of the pallet	8
3.1.2	Long-distance transport	8
3.2	Transport over short distances	8
<b>4</b>	<b>Installation</b>	<b>9</b>
4.1	Mounting the basic implement	9
4.1.1	Mounting the structural steelwork	9
4.1.2	Installation of the hydraulic system	11
4.2	Mounting of the extension kit cat. 0	14
4.2.1	Mounting of the top link cat. 0	14
4.2.2	Installation of lower link and coupling support cat. 0	16
4.3	Mounting of the extension kit cat. 1 with quick catch hook	16
4.4	Mounting the Scanframe extension kit	18
4.5	Mounting the hydraulic extension kit	19
4.6	Installation – pressureless return	21
4.7	Hydraulic extension kit	22
4.8	Installation of the front PTO shaft	23
4.9	Mounting the pressure accumulator	25
4.10	Installation of the hydraulic arrest kit for control lever	26
4.11	Installation of the hose clamp	26
<b>5</b>	<b>Operation</b>	<b>27</b>
5.1	Intended use	27
5.2	Coupling support	27
5.3	Coupling and uncoupling implements	28
5.4	Lowering safeguard for the front power system	28
5.5	Front power system in conjunction with frontloader	29
5.5.1	Front power system with extension kit cat. 0	29
5.5.2	Front power system with extension kit cat. 1	32
5.5.3	Front power system with extension kit Scanframe	32
<b>6</b>	<b>Maintenance</b>	<b>33</b>
6.1	General information	33
6.2	Service	33
6.3	Repair	33
<b>7</b>	<b>Disposal</b>	<b>34</b>
<b>8</b>	<b>Guarantee</b>	<b>34</b>
<b>9</b>	<b>Technical data</b>	<b>34</b>
<b>10</b>	<b>List of illustrations</b>	<b>35</b>
<b>11</b>	<b>EG – Declaration of Conformity</b>	<b>36</b>

### 1      **About this operating manual**

Prior to first use read this operating manual carefully and conscientiously all the way through.

Keep this operating manual where it is easily accessible. This will enable you to refer to important information and handling instructions as needed.

At transfer of the machine the owner of the machine receives instruction in the operation and maintenance of the machine from the owner's sales partner.

The owner must ensure that operating and maintenance personnel have been instructed in full scope in the operation and maintenance of the machine.

Listings with bullet points are marked as follows:

- Text
- Text
- Text . . .

Handling instructions are marked in the sequence in which they should be executed, as follows:

1. Text
2. Text
3. Text . . .

## 2 Safety

Guidelines and instructions with which you must comply, are summarized in this section.

### 2.1 Intended use

The implement must only be used in accordance with its specifications. Please read **chapter 5.1 Intended use** all the way through. All other uses are excluded.

Non-intended use causes:

- Health hazards for the operator or for third parties
- Implement damage
- Environmental damage

### 2.2 Instructions for the owner



**Attention!**

**The front power system should not be charged with downward pressure via the tractor's hydraulic system! For implements that contact the ground or roll on the ground in operation, the tractor hydraulic system must be switched to the float setting! Strictly comply with the manufacturer's recommendation!**



**Danger!**

**The front power system is not suitable for lifting people or for use as a work platform!**



**Danger!**

**Always ensure that no one is in the danger zone before and when using the front power system or the front PTO shaft.**

#### 2.2.1 Qualifications of personnel

This machine must only be operated by persons who are qualified, as follows:

- They must be at least 18 years old.
- They have received instruction on the machine.
- They must have read and understood this operating manual.
- They have been instructed concerning the relevant safety regulations (accident prevention).

The relevant accident prevention regulations and the other generally acknowledged occupational health and safety and road traffic regulations must be complied with at all times.

#### 2.2.2 Instruction

At transfer of the machine the owner of the machine receives instruction in the operation and maintenance of the machine from the owner's sales partner.

The owner must ensure that operating and maintenance personnel have been instructed in full scope in the operation and maintenance of the machine.

### 2.2.3 Accident prevention

The safety regulations and accident prevention regulations are legally regulated in every country. The owner of the machine is responsible for compliance with the valid regulations.

## 2.3 General safety notices

In this section general safety notices/instructions are explained that are used in the subsequent sections.

Comply with these safety instructions to ensure safe operation and to save work time and costs.



**Danger!**  
**Severe injury to the operator or third parties occurs.**  
**Comply with the safety notice.**



**Attention!**  
**Minor injury to the operator or third parties can occur. The tractor, the implement, or the environment can be damaged.**  
**Comply with the safety notice.**



**Note!**  
**Important, helpful tips or information for the operator.**  
**Read this note. It facilitates your work.**



**Attention!**  
**Injuries can occur.**  
**Wear protective work clothing.**

## 2.4 Warnings on the machine

Warnings and their general meaning are specified below that are also affixed as stickers on the implements.



**Attention!**  
**Danger of injury due to moving parts.**  
**Remove the ignition key before performing tasks on the implement.**



**Danger of injury due to rotating parts.**  
**Maintain a safe distance from the area of drive shafts.**  
**Switch off the implement. Wait until all machine parts have come to a standstill before performing tasks on the implement.**



**Attention!**  
**Injuries can occur due to improper operation. The implement can be damaged.**  
**Read the operating manual all the way through.**  
**Comply with the safety instructions.**



**Attention!**  
Injuries due to fluid escaping under high pressure.  
Comply with the notice in the operating manual.



**Attention!**  
Danger of crushing due to moving parts.  
Never reach into the crushing hazard zone if parts are moving or can move.  
Comply with the notice in the operating manual.



**Attention!**  
Danger of injury due to the hydraulic system.  
Do not enter the danger zone unless the lift cylinder safeguard is in place.

### **3 Delivery and transport**

Our implements are delivered in suitable packaging. Please comply with the valid occupational health and safety regulations when unpacking and use suitable hoists if necessary.

#### **3.1 Delivery on a pallet**

##### **3.1.1 Lift the implement off of the pallet**

1. Remove the protective packaging and the transport safeguard.
2. Lift the implement off of the pallet with a suitable device (crane or forklift) and set it down.

##### **3.1.2 Long-distance transport**

If you want to transport the implement over longer distances (e.g. shipping via freight forwarder), you must lash the implement onto a pallet, as it was at delivery.

#### **3.2 Transport over short distances**

Suitable transport equipment or hoists must be used for transport. (Crane, forklift, lift truck)



## 4 Installation



### Danger!

Severe injury to the operator or third parties occurs.

Switch off the tractor and remove the ignition key before mounting or dismounting the implements.

### 4.1 Mounting the basic implement

#### 4.1.1 Mounting the structural steelwork

The basic implement is delivered in component parts. There are extension kits for cat. 0, cat. 1 and Scanframe. The extension kits must be ordered separately.

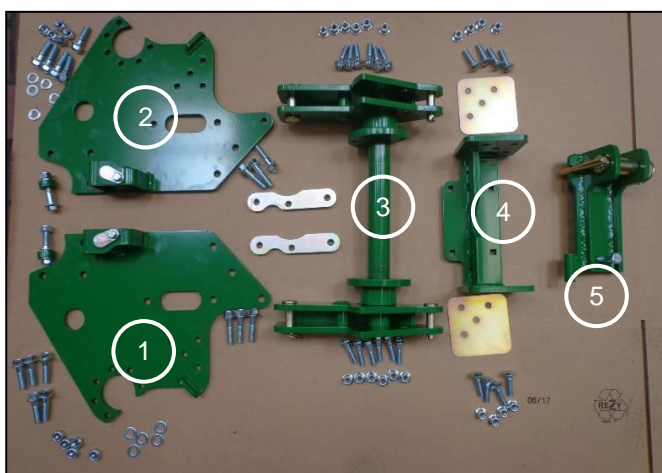

Fig. 1: Front power system – basic implement

1. Side plate left
2. Side plate right
3. Lifting arm
4. Connecting piece
5. Hitch

1. First, screw the side plates onto the tractor frame. Use only the five rear screws M8x45. With the front screws, the extension kit cat. 0, the original JD mower hook-in mechanism and the JD front protective grille are mounted, which would interfere with further mounting.

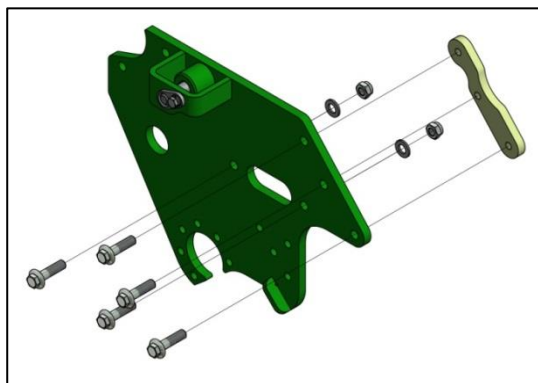

Fig. 2: Mounting of the side plate

2. Mount the connecting piece. Two shims are provided. Use these to compensate tolerances.



Fig. 3: Mounting the connecting piece

3. Mount the lifting arm



Fig. 4: Mounting of the lifting arm

4. Mount the hitch.  
The options, hydraulic extension kit and extension kit cat. 1 are mounted together with the hitch. Before mounting the hitch, please read chapter: 4.3 and 4.5.



Fig. 5: Hitch, mounted with top link cat. 0 and hydraulic extension kit

#### 4.1.2 Installation of the hydraulic system

1. Screw the straight screw fitting G1/4"-8L into the cylinder connections.
2. Mount the cylinders on the front power system. For the bolts with heads, ensure that the bolts are inserted from the inside and that the spring cotter pin is outside.

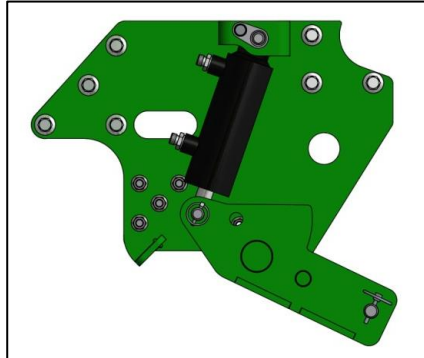

Fig. 6: Hook-in cylinders

3. Mount the holder for the hydraulic hoses on the right side of the tractor frame in the direction of travel.

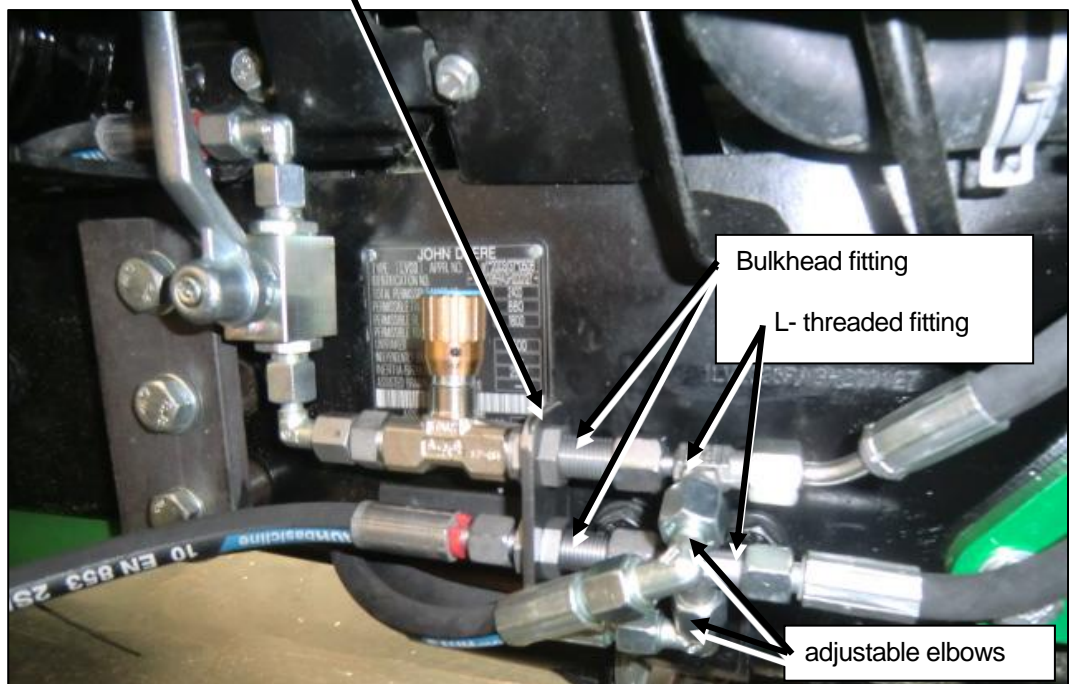

Fig. 7: Hydraulic holder on left side of the tractor frame in the direction of travel

4. Screw the bulkhead fitting with straight connection and the straight screw connection 1/4"-8L into the throttle.
5. Connect the throttle to the ball valve with an adjustable 8L elbow union.
6. Mount the pre-assembled components on the tractor.
7. Mount the second bulkhead fitting as shown.
8. Mount the two L-threaded fittings on the bulkhead fittings.

9. Connect the hydraulic cylinder to the pre-assembled hydraulic system with the hoses 2SC06-320-DKOL-DKOL45, as shown.



Fig. 8: Hydraulic cylinder right

10. Mount the two adjustable elbows on L-threaded fittings (see Fig. 7)
11. Mount the 2SC06-900-DKOL-DKOL45 hoses on the left hydraulic cylinder as shown in the Fig. below. In the Fig. the "pressure accumulator" option is mounted (L-threaded fitting on the upper cylinder connection)

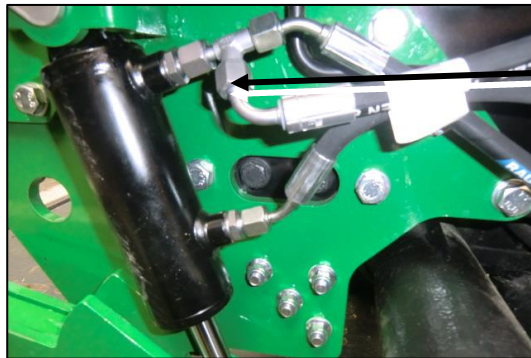

Fig. 9: Cylinder left

12. Place the hoses under the tractor and connect the hoses with the pre-assembled hydraulic system. Strictly ensure that the cylinders are properly connected, otherwise they will move counter to each other and damage the front power system.



Fig. 10: Hose system left to right lift cylinder



13. Secure the hoses with cable ties.
14. Mount the coupling holding on the tractor

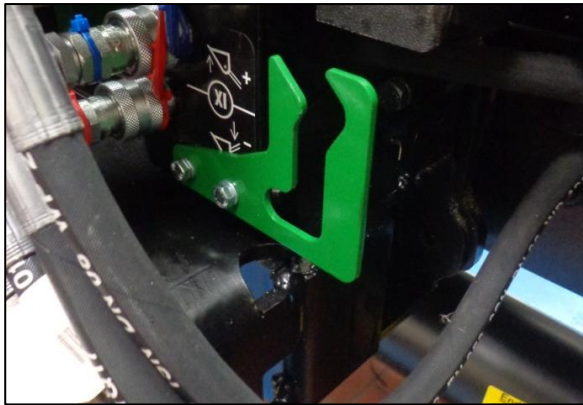

Fig. 11: Coupling holder

15. Mount the 2SN6-550-DKOL-DKOL90 hose on the 90° side of the plug couplings with the straight G1/4"-8L screw fitting and insert the couplings on the tractor.



Fig. 12: Mounting the couplings of the front power system

16. Connect the two hoses to the pre-assembled hydraulic system

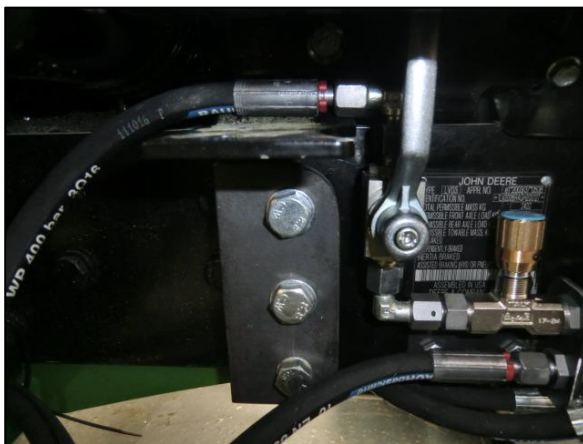

Fig. 13: Hydraulic hoses from the control device

17. If you then want to mount the extension kit cat. 1, fasten the front power system with the front three M12x50 screws.
18. If you are mounting the JD front protective grille in conjunction with the extension kit cat. 1 you need the provided spacer washer and the M12x60-10.9 screw

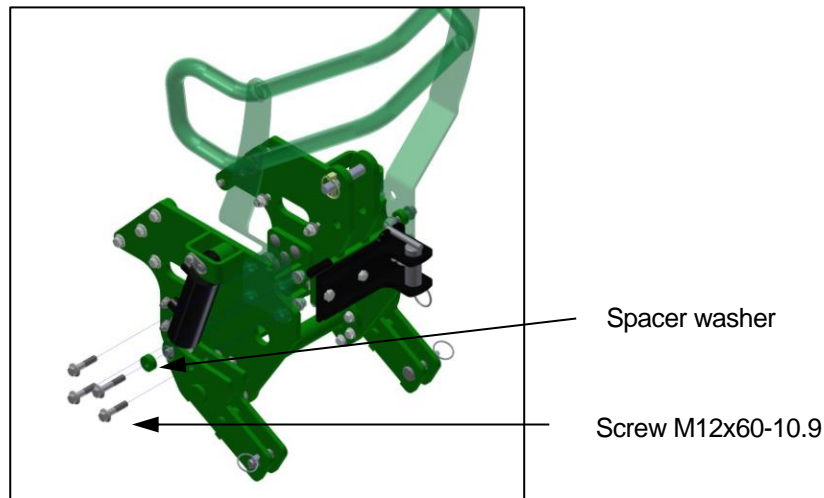

Fig. 14: Mounting the front protective grille with extension kit cat. 1

19. Check the function and conclude the installation of the basic implement.

## 4.2 Mounting of the extension kit cat. 0

### 4.2.1 Mounting of the top link cat. 0

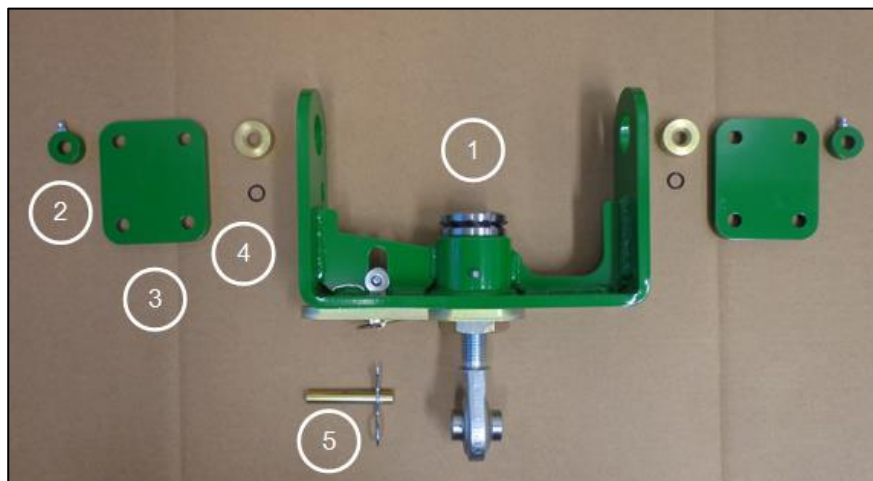

Fig. 15: Top link cat. 0

1. Top link
2. Lubricating adapter with lubricating nipple
3. Side plate is required if a JD front protective grille is not installed.
4. Lubricating adapter, inner, with O-ring 12x2
5. Safety bolt with splint

1. Mount the side plates (3), or the John Deere front protective grille with three DIN 6921-M12x50 screws, DIN 125-13 washers, and three DIN 985-M12 self-securing nuts. The screws are in the package of the basic implement (-> Fig. 1)



Fig. 16: Installing the side plate

2. Place the lubricating adapters with O-ring (4) in the bores of the top link. Pay attention to the position of the lubricating bore (-> Fig. 17). The O-ring is between the lubricating adapters and the tractor frame.

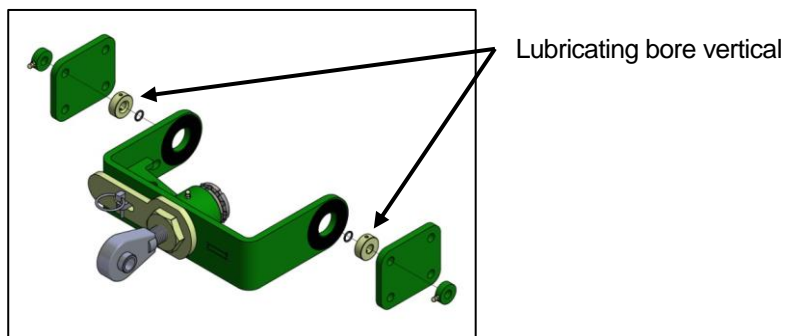

Fig. 17: Mounting the top link

3. Fasten the top link with two DIN 6921-M12x60-10.9, screws, DIN 125-13 washers, and DIN 985-M12 self-locking nuts. Tighten the screw with a torque of 140 Nm.
4. Mount the safety bolt with cotter pin (5) as shown in Fig. 18.



Fig. 18: Top link cat. 0 installed

5. Check all screw connections and conclude the installation.

### 4.2.2 Installation of lower link and coupling support cat. 0

1. Plug the lower link into lifting arm and secure the lower link with the bolts.
2. Mount the coupling support on the lower link and the top link. For attachment select variant A or B. Variant A is shown in Fig 19 **Fehler! Verweisquelle konnte nicht gefunden werden..**

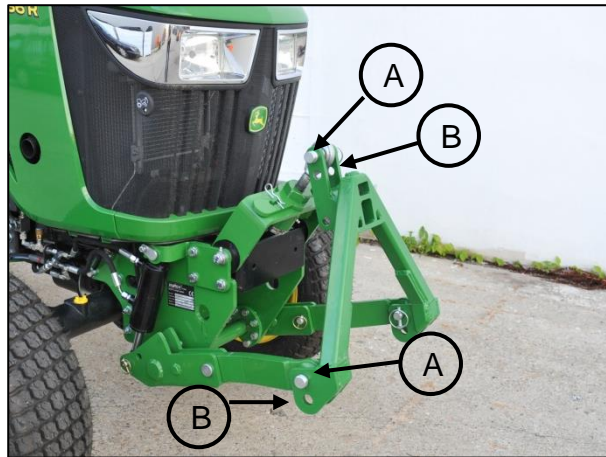

Fig. 19: Lower link and coupling triangle cat. 0

### 4.3 Mounting of the extension kit cat. 1 with quick catch hook

1. Mount the top link holder together with the hitch. If you have ordered the hydraulic extension kit option, the coupling holder is bolted onto the top link holder. Use the DIN 931-M12x50 and DIN 7991-M12x50 screws, the DIN 985-M12 nuts, and the DIN 125-13 washers.

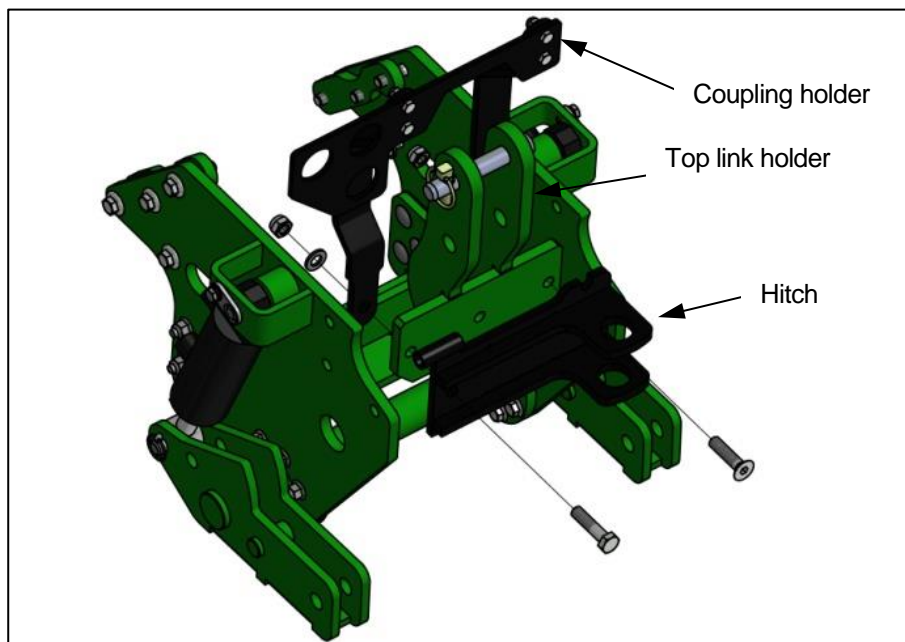

Fig. 20: Mounting the top link holder cat. 1



## 2. Mounting the lower link cat. 1

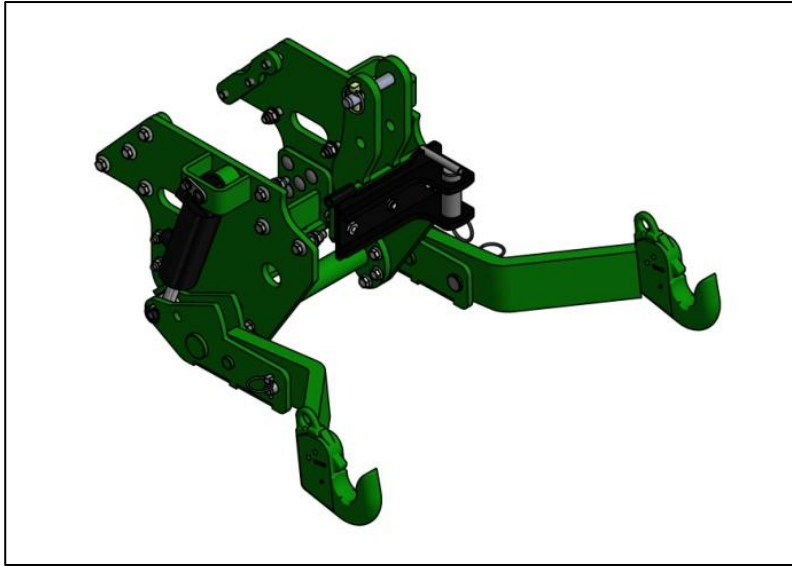

Fig. 21: Lower link cat. 1

3. If you are attaching an implement or our quick-coupling triangle, always ensure that the top link is hooked in at the correct position, otherwise the tractor can be damaged. Strictly ensure that a collision cannot occur in the top-most position of the front power system.

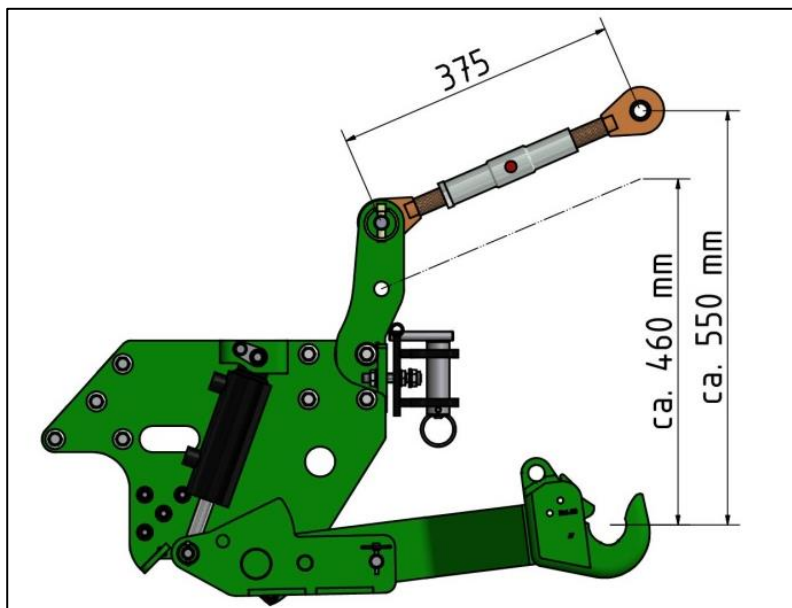

Fig. 22: Position of the top link cat. 1

### 4.4 Mounting the Scanframe extension kit

1. Mount the top link and the lower link, as described in chapters 4.2.1 and 4.2.2.
2. Adjust the top link to approx. 260 mm.

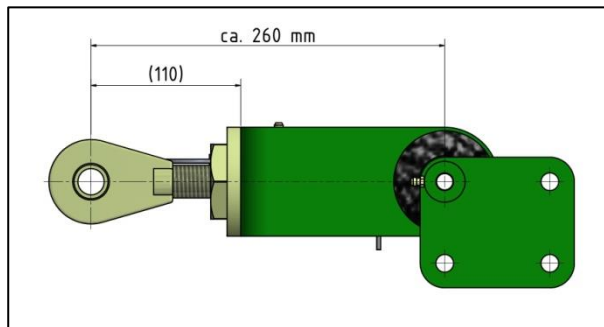

Fig. 23: Top link adjustment gauge for Scanframe

3. Mount the coupling support as shown in the Fig. below.



#### **Attention!**

**If the coupling support is mounted incorrectly there is danger that the top link will damage the tractor.**

**When adjusting the coupling support to your implement pay attention to the illustrations shown below.**

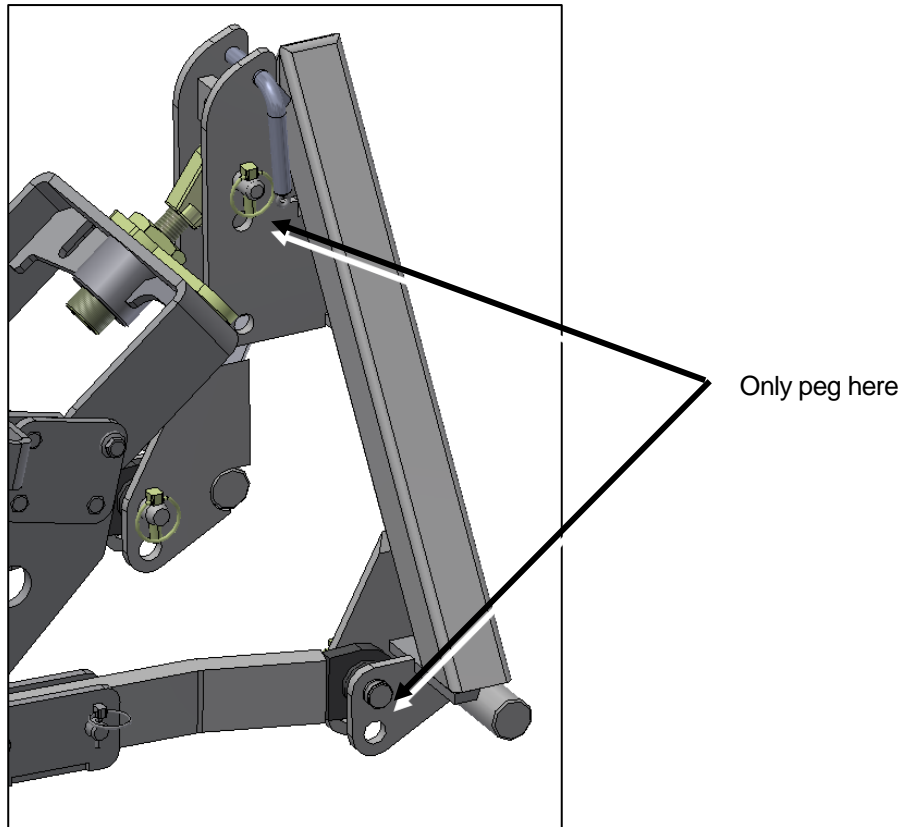

Fig. 24: Scanframe coupling support

## 4.5 Mounting the hydraulic extension kit

You can order the hydraulic extension kit with size 3 couplings or with size 2 drip-free couplings.

1. Mount the holder for the hydraulic extension kit together with the hitch. If you have ordered the extension kit cat. 1, then the holder is mounted on the top link holder.

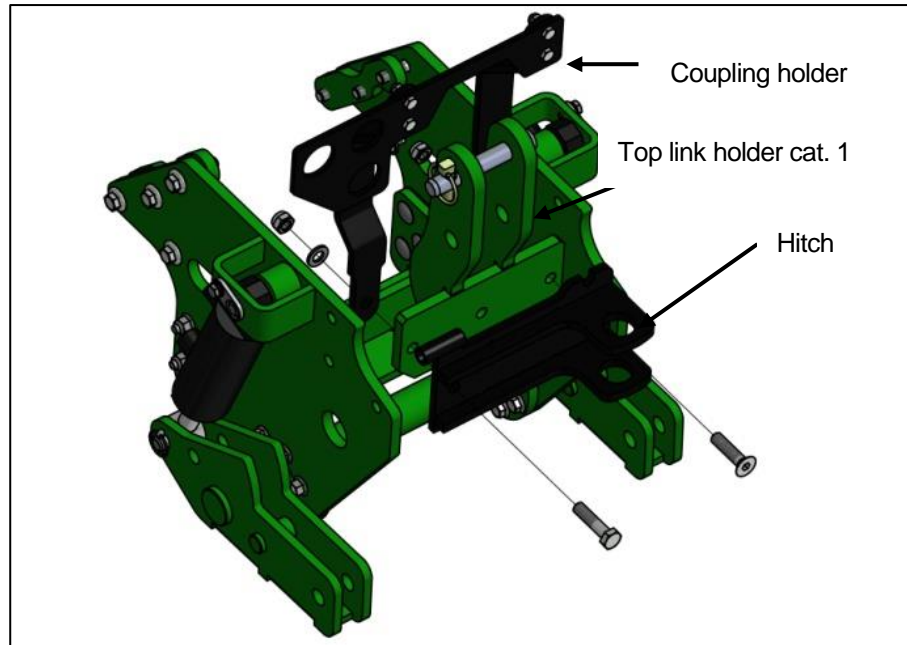

Fig. 25: Mounting the hydraulic extension kit

2. Mount the size 1 couplings on the 90° elbow of the hydraulic hose.

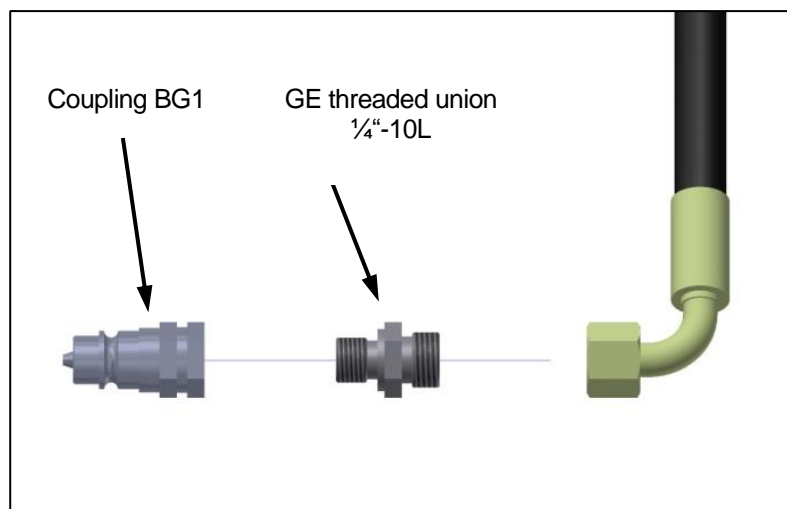

Fig. 26: Mounting the size 1 coupling

3. Insert the couplings on the tractor hydraulic system and place the hoses on the tractor frame for the front power system, as shown in the Fig. below. On the photo in addition a pressureless return is installed.



Fig. 27: Hydraulic extension kit

4. Mount the hydraulic hoses as shown in Fig. 27.
5. Mount the BG3 couplings or BG2 drip-free

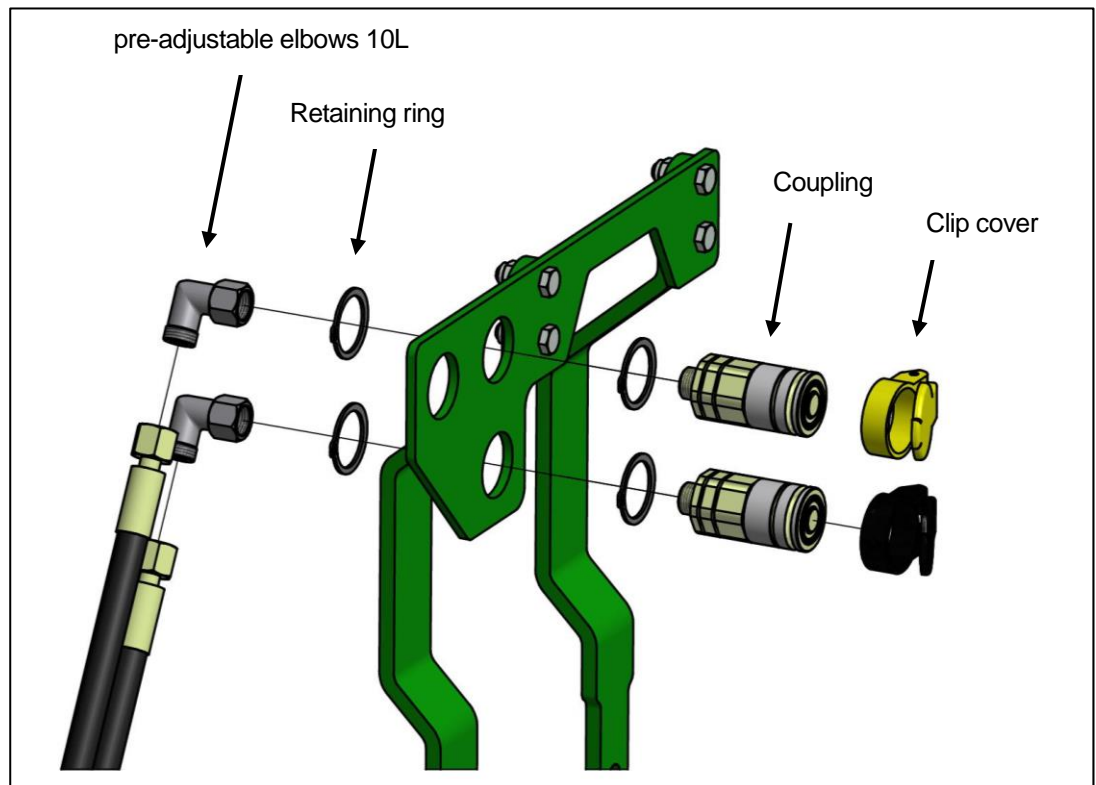

Fig. 28: Mounting the couplings – hydraulic extension kit

6. Secure the hydraulic lines with cable ties.

## 4.6 Installation – pressureless return

The pressureless return is connected on the gearbox, on the connection for the pressureless return of the 2nd control device. Without 2nd control device the connection for the control

device is sealed with a plug. If the tractor has a 2nd Control device, this is how the elbow in the gearbox must be replaced by the provided L-connection.

1. Mount the provided L-threaded fitting on the gearbox. If your tractor has a 2nd control device then mount the pressureless return of the control device on the L-threaded fitting, otherwise seal the connection with the provided plug.

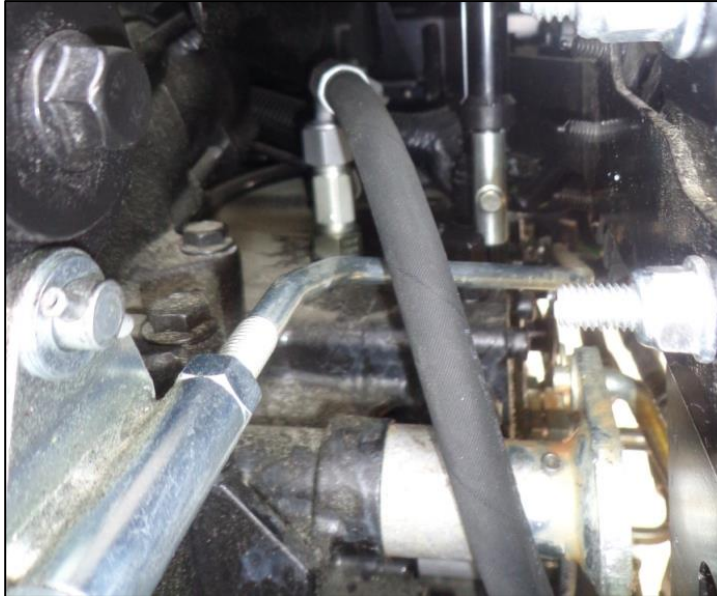

Fig. 29: Mounting the pressureless return on the gearbox

2. Mount the hydraulic hose on the L-connection.



Fig. 30: Lay out the pressureless return

3. Lay the hose under the vehicle to the front.





Fig. 31: Return on the tractor frame

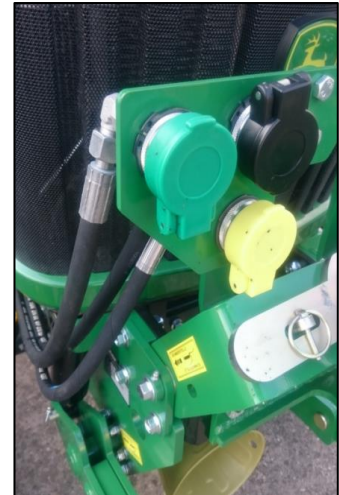

Fig. 32: Socket

4. Lay out the hydraulic hose along the tractor frame to the front.
5. Mount the coupling as shown in Fig. 32.
6. Fasten the hydraulic line with cable ties.

## 4.7 Hydraulic extension kit

For the hydraulic extension kit a free hydraulic circuit must be present on the rear of the tractor. This free hydraulic circuit is laid out from the rear forward to the front power system.

Lay out the hydraulic hoses along the tractor frame on the left in the direction of travel, to the front.

The provided holder and the plug-in couplings are mounted as shown on Fig. 33.

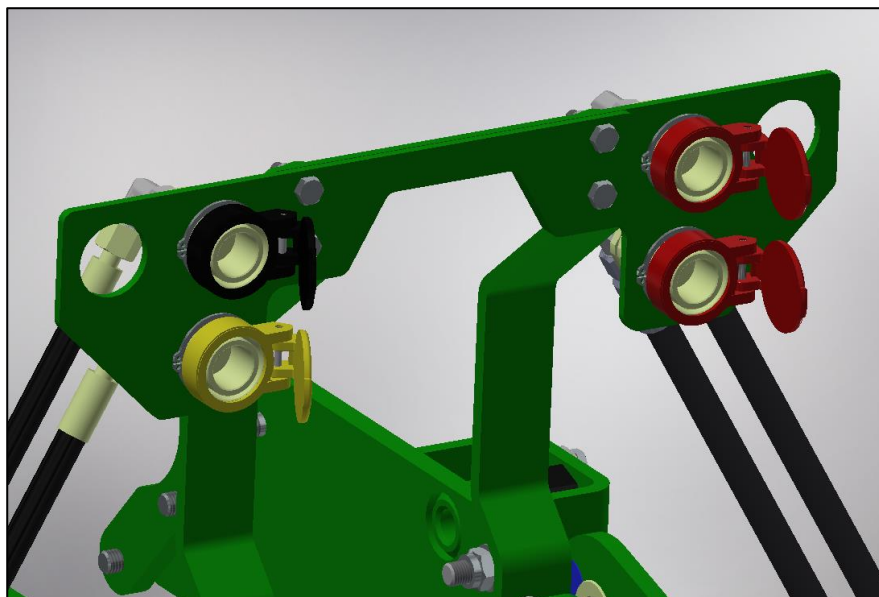

Fig. 33: Socket for couplings

### 4.8 Installation of the front PTO shaft

1. Mount the holder for the front PTO shaft on the front power system.



Holder for drive shaft

Fig. 34: Installation of the front PTO shaft on the front power system

2. Mount the drive shaft on the holder

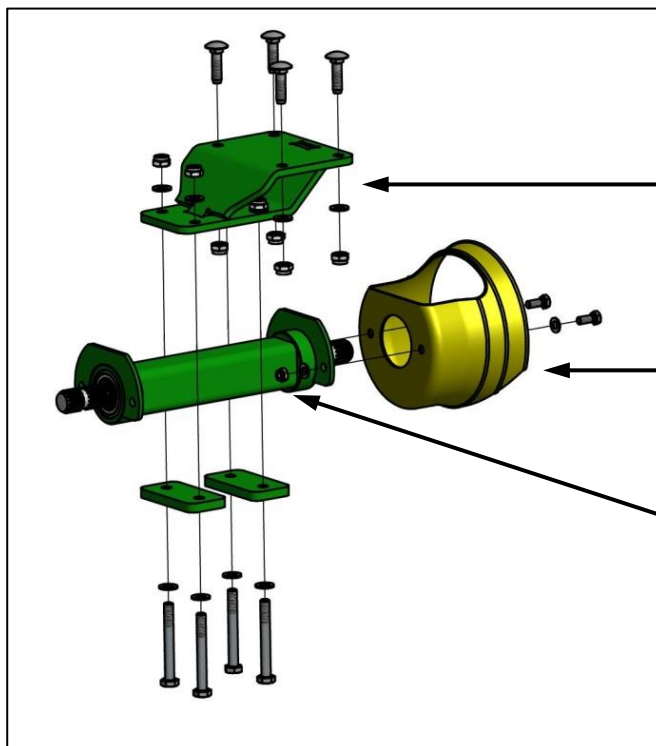

Holder for drive shaft

Protective pot

Drive shaft

Fig. 35: Mounting the drive shaft



3. Mount the holder for the fastening of the protective tube on the tractor

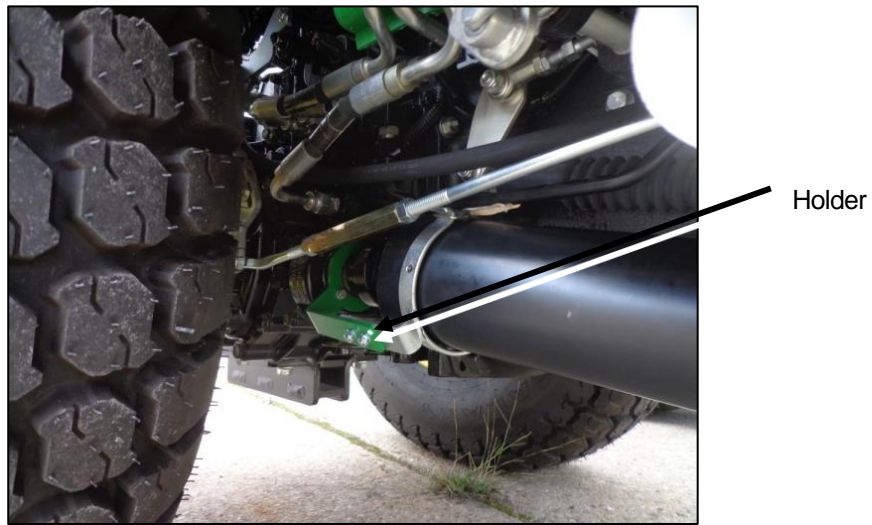

Fig. 36: Holder for protective tube, rear

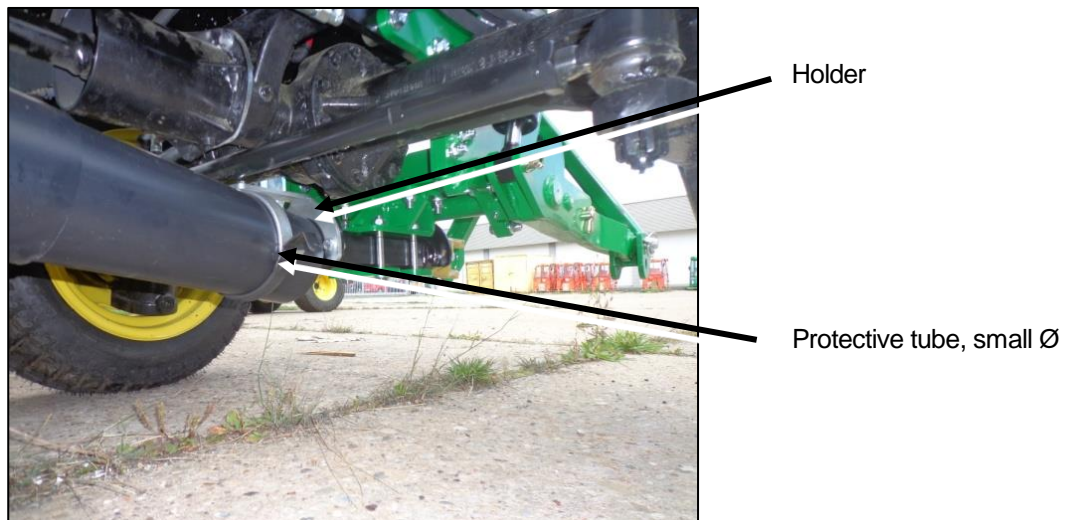

Fig. 37: Holder for protective tube, front

4. Mount the protective tube with the provided rubber straps.  
The tube with the smaller diameter is fastened on the drive shaft.
5. Mount the protective pot (see Fig. 35)

### 4.9 Mounting the pressure accumulator

The pressure accumulator serves as a shock absorber for heavy implements, when these are transported lifted out.

1. Mount the holder with the pressure accumulator on the left side of the tractor.



Fig. 38: Pressure accumulator

2. Lay out the hydraulic hose for the front power system
3. Connect the pressure accumulator on the lift cylinder with the L-threaded fitting.



Fig. 39: Pressure accumulator – hydraulic system

4. Retighten all screw connections and conclude the installation.

#### 4.10 Installation of the hydraulic arrest kit for control lever

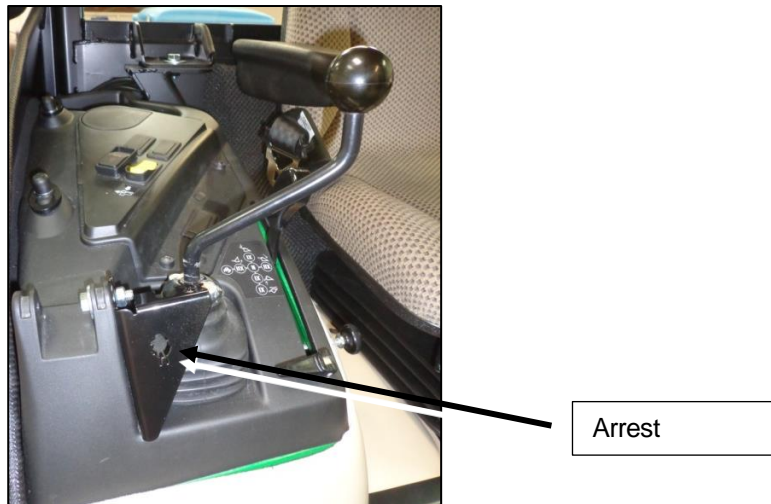

Fig. 40: Installation of the arrest kit

#### 4.11 Installation of the hose clamp

The hose clamp is available as a single and as double hose clamp. The holder is identical.

1. Mount the holder on the tractor frame.

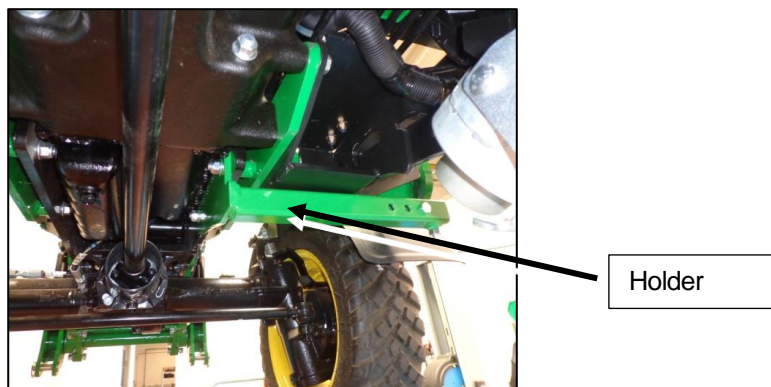

Fig. 41: Holder for hose clamp

2. Mount the hose clamp



Fig. 42: Double hose clamp

## 5 Operation



### Attention!

The front power system should not be charged with downward pressure via the tractor's hydraulic system! For implements that contact the ground or roll on the ground in operation, the tractor hydraulic system must be switched to the float setting! Strictly comply with the manufacturer's recommendation!



### Danger!

The front power system is not suitable for lifting people or for use as a work platform!



### Danger!

Always ensure that no one is in the danger zone before and when using the front power system or the front PTO shaft.

### 5.1 Intended use

The front power system is used to accommodate small to medium-sized implements, such as snow blades, sweepers, etc. The front PTO shaft extends the mid-mount PTO shaft of the tractor to the front. It is used to power sweepers, or similar implements that are driven with PTO shafts.

All other uses are excluded.

Non-intended use causes:

- Health hazards for the operator or for third parties
- Damage to the tractor and the implements
- Environmental damage

### 5.2 Coupling support



#### Attention!

If the coupling support is mounted incorrectly there is danger that the tractor will be damaged.

When adjusting the coupling support pay attention to the instructions in chapter 4.2, 4.3, and 4.4

## 5.3 Coupling and uncoupling implements



### Note!

**Comply with the axle loads specified by the tractor manufacturer**

1. Drive the tractor forward in front of the implement.
2. Lower the front power system hydraulically.
3. Drive slowly toward the implement until the coupling support of the tractor is under the coupling triangle of the implement.
4. Slowly lift the front power system hydraulically until the implement is slightly lifted.
5. Secure the implement with the appropriate triangle locking mechanism. The triangle locking mechanism depends on the type of implement.

## 5.4 Lowering safeguard for the front power system



### Note!

**Use the lowering safeguard for:**

- Road travel
- Driving between work locations
- Cleaning and maintenance tasks

1. Lift the front power system.
2. Activate the stop valve by pulling it out and swinging it 90 degrees. The lowering safeguard is locked.

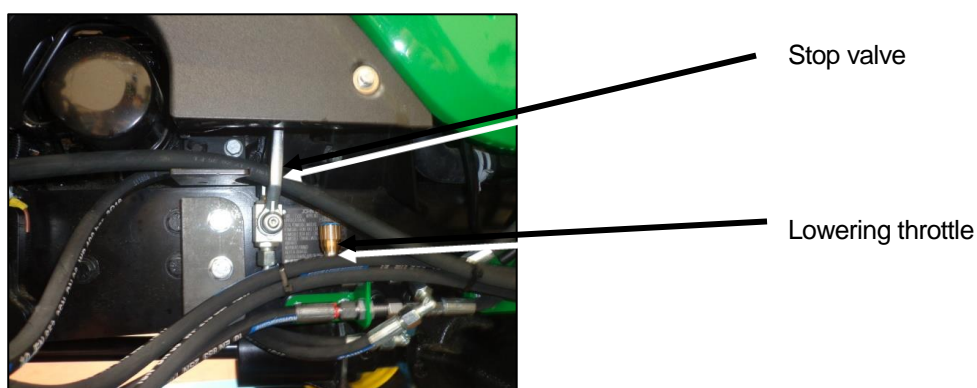

Fig. 43: Lowering safeguard, shown in unlocked position

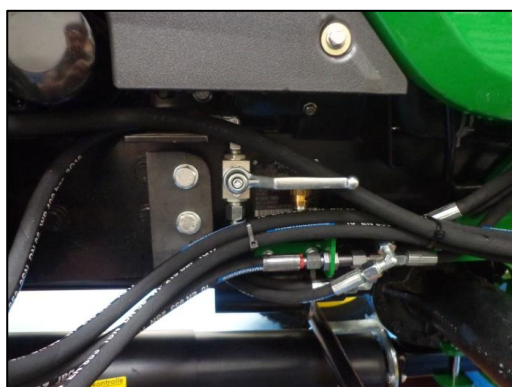

Fig. 44: Lowering safeguard shown locked



### 5.5 Front power system in conjunction with frontloader.

#### 5.5.1 Front power system with extension kit cat. 0

Front power system in conjunction with the cat. 0 extension kit is optimized for operation with a John Deere 220R Frontloader.



Fig. 45: Front power system with frontloader

To operate the frontloader, the front power system must be brought into park position.

1. Completely Lift out the front power system.
2. Switch off the engine of the tractor.
3. Lock the lowering safeguard
4. Dismount the coupling support
5. Dismount the lower cylinder bolt.



Lower cylinder bolt

Fig. 46: Front power system lifted out

6. Swing up the lower link. The cylinders engage on the locking mechanism.
7. Remount the lower cylinder bolt without (without bore)

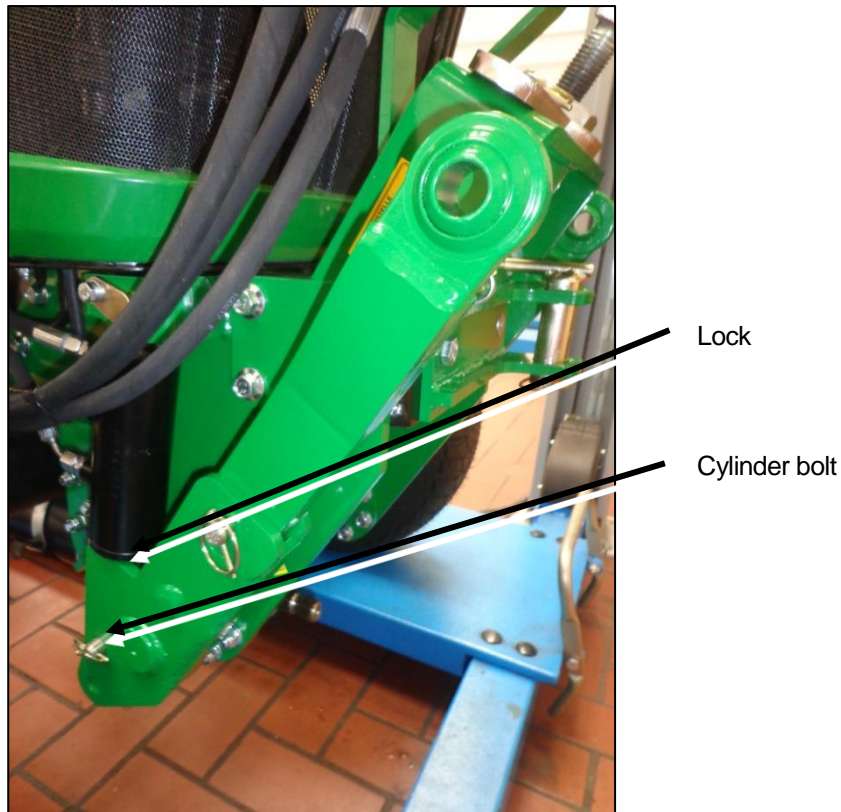

Fig. 47: Lower link swung up

8. Swing up the top link and secure it with the bolt.



Fig. 48: Top link swung up

9. With the option "arrest for coupling triangle" (order no. 8606) you can fasten the coupling triangle in parking position. To do this, it may be necessary to adjust the length of the top link.



Fig. 49: Arrest for the coupling support cat. 0

If the arrest is not required, it can be fastened on the coupling support.



Fig. 50: Arrest on the coupling support



To bring the front power system back into work position, proceed in the reverse sequence. The cylinders automatically engage in the lock. To prevent this, you can insert the bolt into the cylinder eye, the bolt attaches on the stop and you have one hand free to continue the installation.



Fig. 51: Arrest for lift cylinder

### 5.5.2 Front power system with extension kit cat. 1

To operate the frontloader with a front power system with extension kit cat. 1, the coupling support, the lower link, and the top link must be dismantled.

The lift arm must be swung up as described in chapter 5.5.1.

### 5.5.3 Front power system with extension kit Scanframe

To operate the front loader with a front power system with Scanframe extension kit the coupling support must be dismantled.

The lift arm and the top link must be swung up as described in chapter 5.5.1. There is no arrest for the coupling support.

## 6 Maintenance

### 6.1 General information



#### **Attention!**

**Personal injury or damage to the tractor and the implements can occur. Before each use, check all safety-relevant parts, the hydraulic connections, and all threaded unions.**

### 6.2 Service



#### **Attention!**

**Danger of injury due to moving parts.**

**Remove the ignition key before performing maintenance tasks on the implement.**

After 25 operating hours, at the start of the season, or after a longer standstill period:

- Grease the moving parts of the implement via the lubricating nipples.
- Check the seat, status and seal of the hydraulic lines
- Before and after each use check all threaded unions for firm seat and re-tighten them if necessary

### 6.3 Repair

If there are faults, problems, or other indications of malfunction, contact your sales partner.

## 7 Disposal

The implements must be disposed of in accordance with the applicable regulations of the municipality or the country.

Take the parts to the collection points for residual waste, special waste, or recycle them depending on material.

matev GmbH does not provide any disposal services.

## 8 Guarantee

The General Terms & Conditions of matev GmbH provide information on the guarantee conditions.

## 9 Technical data

Front power system FPS-JD 2036R	Data
Hydraulic cylinder	Two double-acting cylinders arranged on the side
Lift force	Do not exceed the permissible axle loads of the vehicle! 600 kg - 600 mm in front of coupling point
Lift height	110 mm – 430 mm, on the coupling point of the lower arms
Distance in front of the axle	approx. 725 mm in work position (cat. 0)
Weight	Approx. 75 kg removal cat. 0

Front PTO shaft	Data
Weight	35 kg

## 10 List of illustrations

Fig. 1: Front power system – basic implement.....	9
Fig. 2: Mounting of the side plate .....	9
Fig. 3: Mounting the connecting piece .....	10
Fig. 4: Mounting of the lifting arm .....	10
Fig. 5: Hitch, mounted with top link cat. 0 and hydraulic extension kit .....	10
Fig. 6: Hook-in cylinders .....	11
Fig. 7: Hydraulic holder on left side of the tractor frame in the direction of travel .....	11
Fig. 8: Hydraulic cylinder right .....	12
Fig. 9: Cylinder left .....	12
Fig. 10: Hose system left to right lift cylinder .....	12
Fig. 11: Coupling holder.....	13
Fig. 12: Mounting the couplings of the front power system .....	13
Fig. 13: Hydraulic hoses from the control device .....	13
Fig. 14: Mounting the front protective grille with extension kit cat. 1 .....	14
Fig. 15: Top link cat. 0.....	14
Fig. 16: Installing the side plate .....	15
Fig. 17: Mounting the top link .....	15
Fig. 18: Top link cat. 0 installed .....	15
Fig. 19: Lower link and coupling triangle cat. 0 .....	16
Fig. 20: Mounting the top link holder cat. 1 .....	16
Fig. 21: Lower link cat. 1 .....	17
Fig. 22: Position of the top link cat. 1 .....	17
Fig. 23: Top link adjustment gauge for Scanframe .....	18
Fig. 24: Scanframe coupling support .....	18
Fig. 25: Mounting the hydraulic extension kit .....	19
Fig. 26: Mounting the size 1 coupling .....	19
Fig. 27: Hydraulic extension kit.....	20
Fig. 28: Mounting the couplings – hydraulic extension kit .....	20
Fig. 29: Mounting the pressureless return on the gearbox .....	21
Fig. 30: Lay out the pressureless return .....	21
Fig. 31: Return on the tractor frame                      Fig. 32: Socket.....	22
Fig. 33: Socket for couplings .....	22
Fig. 34: Installation of the front PTO shaft on the front power system .....	23
Fig. 35: Mounting the drive shaft.....	23
Fig. 36: Holder for protective tube, rear .....	24
Fig. 37: Holder for protective tube, front.....	24
Fig. 38: Pressure accumulator .....	25
Fig. 39: Pressure accumulator – hydraulic system .....	25
Fig. 40: Installation of the arrest kit.....	26
Fig. 41: Holder for hose clamp .....	26
Fig. 42: Double hose clamp.....	26
Fig. 43: Lowering safeguard, shown in unlocked position .....	28
Fig. 44: Lowering safeguard shown locked .....	28
Fig. 45: Front power system with frontloader .....	29
Fig. 46: Front power system lifted out .....	29
Fig. 47: Lower link swung up .....	30
Fig. 48: Top link swung up.....	30
Fig. 49: Arrest for the coupling support cat. 0.....	31
Fig. 50: Arrest on the coupling support .....	31
Fig. 51: Arrest for lift cylinder .....	32

  
Georg Hemmerlein  
Managing Director